



1250-1280 E / Dual Power, Quick guide

This guide is intended for quick consultation only and does not replace the user and maintenance manual.

Before using the machine, read the user and maintenance manual contained in the machine's packaging thoroughly and strictly follow all the instructions.

PREPARATION & OPERATION

Switch the machine on by turning the ignition key to position 1.

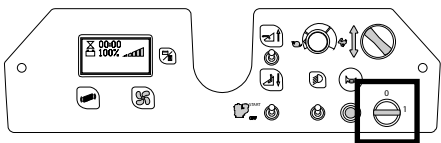

Lower the main brush.

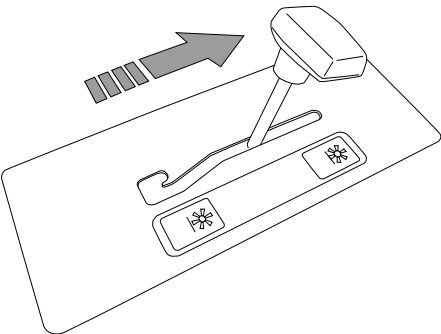

Lower the side brushes.

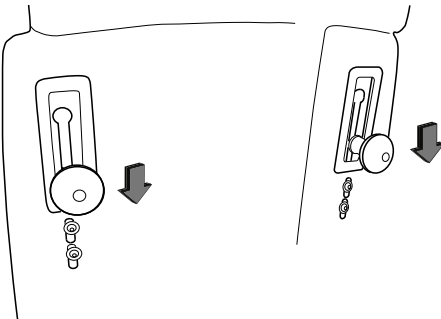

Choose the direction of travel using the selector

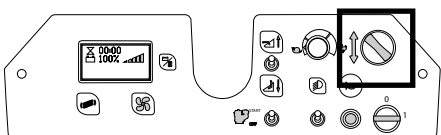

Press the accelerator pedal to start travel.

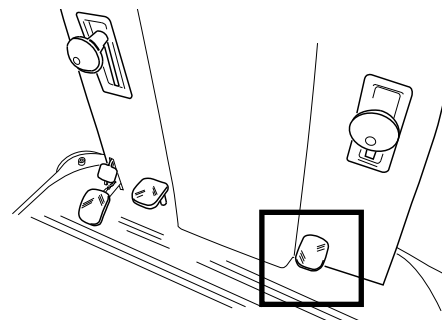

Adjust the machine's speed using the potentiometer.

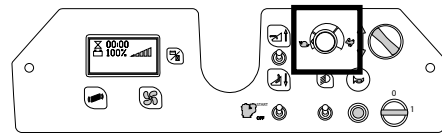

DUAL POWER version.
Start the engine by temporarily moving the selector to START.

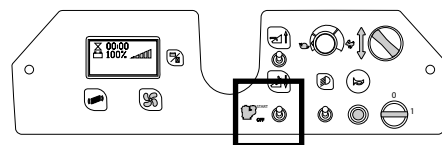

To collect voluminous objects, press the front flap lift pedal

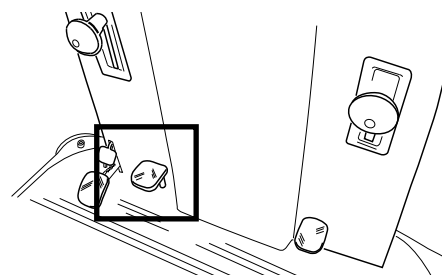

To stop the machine, press the brake pedal, which also acts as parking brake, using the special locking lever.

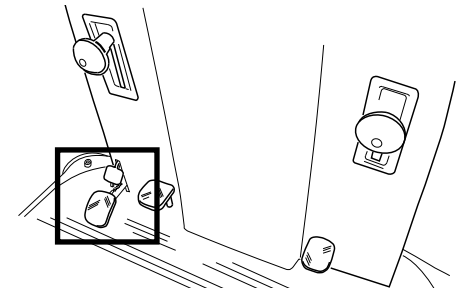

Emptying the bottom unloading debris bin, model 1250:

- Release the bin lock.
- Pull out the rear bin by means of its handle.
- Take the bin (which is fitted with wheels) to the rubbish collection point and empty it.

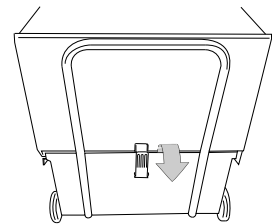

Emptying the bottom unloading debris bin, model 1280:

- Lift the bin to the desired height, holding the enabling button and moving the selector located on the instrument panel.
- Pull the lever to rotate the bin and empty its contents.

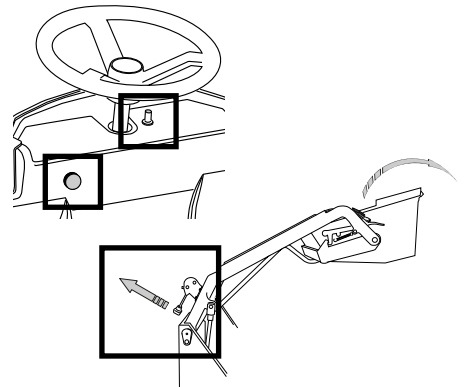



DAILY MAINTENANCE

When you have finished cleaning, proceed as follows:

- Turn the machine off.
- Activate the parking brake.
- Raise the centre brush and the side brushes, to prevent damage.
- Recharge the batteries if necessary, using the connector provided.

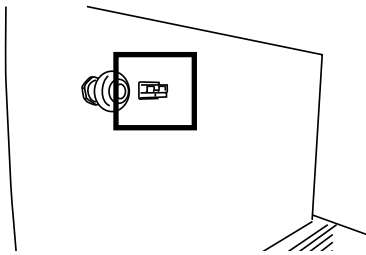

When having finished working, activate the filter shaker for 10 seconds.

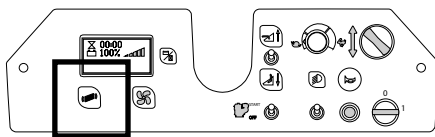

Empty the debris bin.

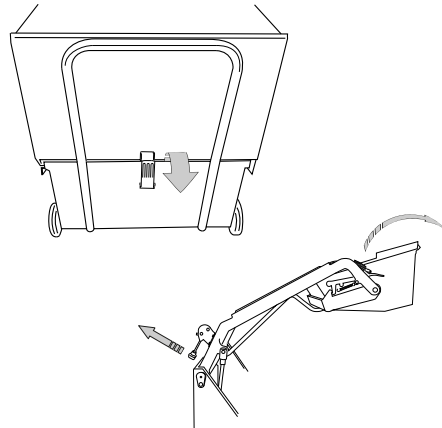

Check and remove any debris wrapped around the side brushes and on the centre brush.

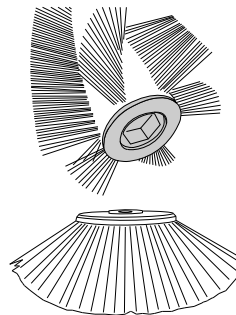

WEEKLY MAINTENANCE

Check the level of electrolyte in the batteries, if using acid batteries.

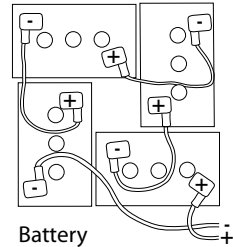

Check that the suction filter is tight and clean.

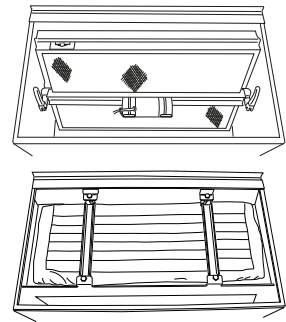

REPLACING THE CENTRE BRUSH

- Unscrew the knob and open the door on the left of the machine.
- Unscrew the three knobs securing the brush compartment cover.
- Pull out the brush cover compartment.
- Remove the brush, holding it on the plastic core.
- Remove the adapter from the core of the old brush and fit it to the new brush, taking care to keep the bristles aligned in the same direction.
- Fit the new brush and make sure that the adapter is inserted on the drive hub.
- Replace the brush compartment cover using the knobs, following the dismantling operations in reverse order.

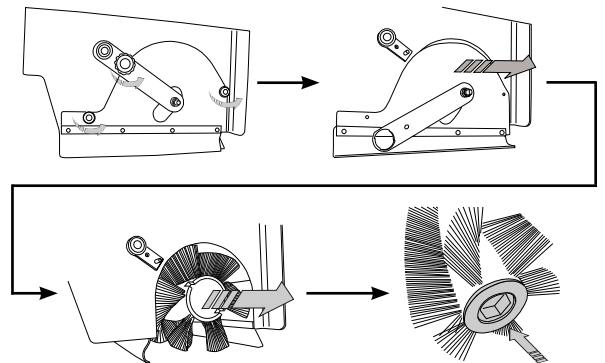

ADJUSTING CENTRE BRUSH PRESSURE

- Unscrew the knob indicated.
- Turn the lever anticlockwise to increase pressure, making sure to align the knob fastening hole.
- Screw the knob back on.

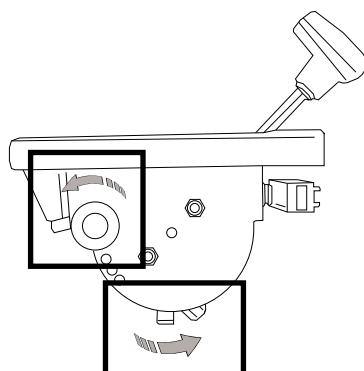

ADJUSTING SIDE BRUSH HEIGHT

- Move the side brushes to the working position.
- Loosen the two adjustment screws underneath the brush lifting knob.
- Manually move the brush to the required position.
- Tighten the adjustment screws.

