

This Guide is intended for quick consultation only and does not replace the Use and Maintenance Manual. Before using the machine, read the Use and Maintenance Manual contained in the machine packaging thoroughly and rigorously respect all the instructions.

PREPARATION/ OPERATION

Fill the detergent tank.

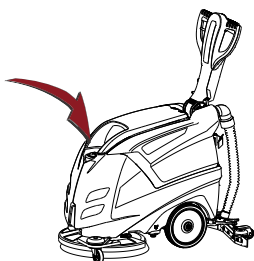

Adjust the slope of the handle by pulling the handle release lever.

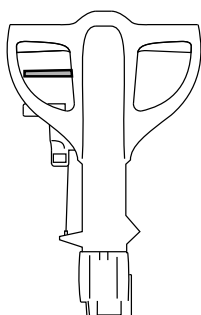

Lower the squeegee using the lever.

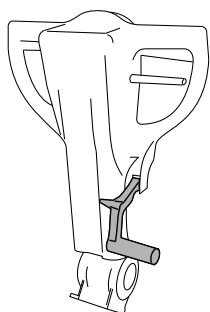

Open the detergent tank tap.

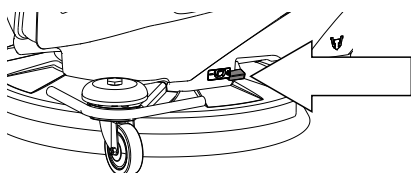

Press the ON button.

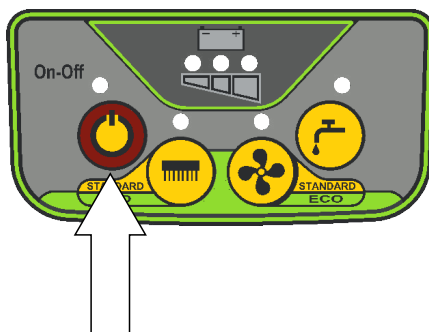

Press the brush button to activate suction and water delivery.

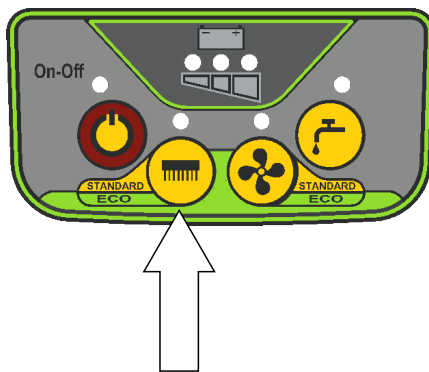

Operate the drive lever.

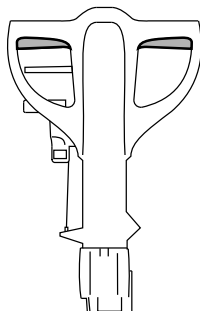

Begin working.

When you have finished cleaning, proceed as follows:

- Press the brush button.
- Turn the machine off by pressing the ON button for at least 4 seconds.
- Raise the squeegee.
- Close the detergent tank tap.
- If needing to recharge the batteries, connect the power cable to the battery charger or connect the external battery charger to the connector highlighted in the photo.

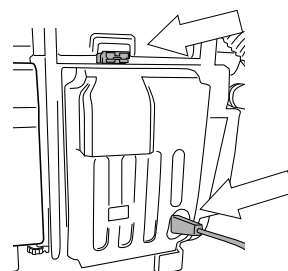

DAILY MAINTENANCE

Empty the dirty water tank.

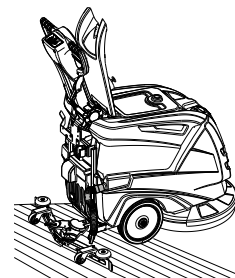

Clean the dirty water tank.

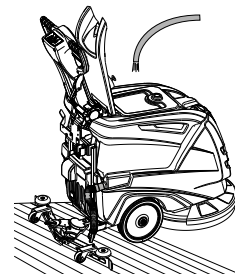

Check the detergent output filter is undamaged and clean.

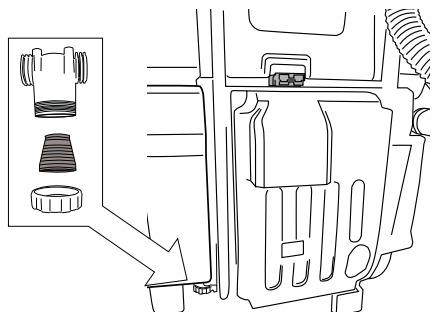

Clean the brush.

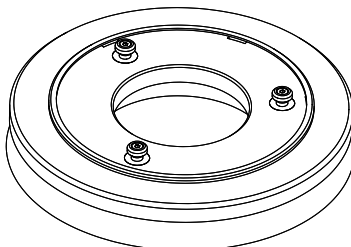

Check the battery charge (BATTERY VERSION).

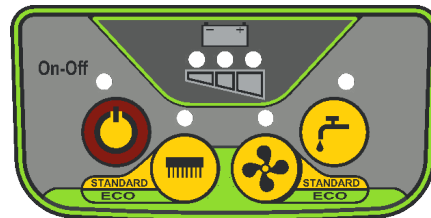

Check the dirty water tank float is undamaged and clean and moves freely on the pin.

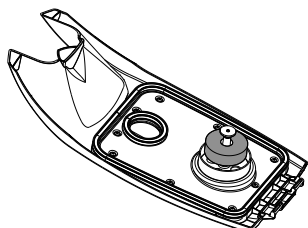

Check the squeegee is clean and the blades are not damaged.

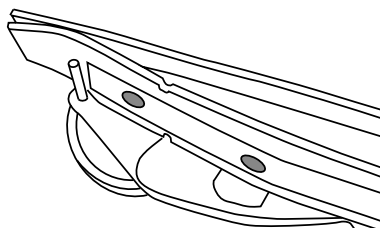

If needing to recharge the batteries, connect the power cable to the battery charger or connect the external battery charger to the connector highlighted in the photo.

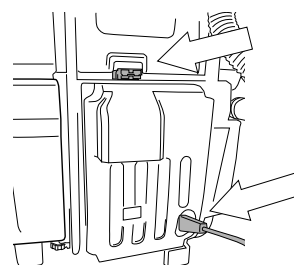

REPLACING THE SQUEEGEE BLADES

- Release the clip
- Remove the two blade retainers by pushing them towards the outside of the squeegee then extracting them.
- Remove the blade.
- Reuse the same blade by reversing the edge in contact with the floor until all four edges are worn out, or replace with a new blade, fitting it onto the screws on the body of the squeegee.
- Reposition the two blade retainers by centring the widest part of the slots over the fixing screws on the squeegee body, then pushing the blade retainers inwards.
- Fasten the clip.

AUTOMATIC BRUSH ATTACHMENT

Attaching the brush:

- rest the brush on the floor in front of the machine. Raise the front of the machine by levering on the handle, then lower it onto the brush, centring it with the brush cover. Action the drive lever repeatedly until the brush engages..

Removing the brush:

- Raise the front of the machine by levering on the handle, then operate the brush lever repeatedly. After operating the lever a few times, the brush is released and falls to the ground..

THE MACHINE DOES NOT COME ON/START UP	CHECK THE BATTERY CHARGE (BATTERY VERSION)
	CHECK THE POWER CABLE IS PLUGGED INTO A FUNCTIONING SOCKET (CABLE VERSION)
THE MACHINE LEAVES THE FLOOR WET	CHECK THE SQUEEGEE BLADES ARE NOT WORN
	CHECK THERE IS NO DEBRIS BETWEEN THE TWO SQUEEGEE BLADES
	CHECK THERE IS NO DEBRIS IN THE SUCTION HOSE
	CHECK THE DIRTY WATER TANK IS NOT FULL
	CHECK THE DETERGENT TANK LID IS CLOSED CORRECTLY
THE MACHINE LEAVES THE FLOOR DIRTY	CHECK THE SUCTION HOSE IS CORRECTLY ATTACHED TO THE SQUEEGEE
	CHECK THE TYPE OF BRUSH IN USE IS SUITABLE FOR THE TYPE OF DIRT AND FLOOR.
THE MACHINE LEAVES STRIPES OF WET FLOOR	CHECK THE FLOOR HAS BEEN BRUSHED BEFORE USING THE MACHINE
	CHECK THERE IS NO DEBRIS BETWEEN THE TWO SQUEEGEE BLADES
	CHECK THE SQUEEGEE BLADES ARE NOT WORN
	CHECK THE SQUEEGEE IS CORRECTLY ADJUSTED